



STORAGE\_EURODUTO



LINEA  
GRAN\_VOLUME



ogni giorno più di  
1.000.000 km di scaffali  
tengono in ordine  
i vostri prodotti

**40°**  
1973 - 2011

every day more than a  
1.000.000 km shelving  
systems maintain your  
products in order



**SOSTEGNO OMEGA**  
*Omega support*  
*Support Omega*  
*Omegabefestigung*

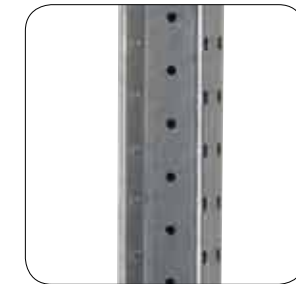

**SPALLA**  
*Frame*  
*Echelle*  
*Rahmen*



**CORRENTE**  
*Beam*  
*Lisse*  
*Längstraversen*



**TRAVERSI E DIAGONALI**  
*Horizontal and diagonal braces*  
*Traverses et diagonales*  
*Traversen und Quertraversen*



**PIASTRA DI BASE**  
*Base plate*  
*Plaque de base*  
*Grundplatte*

Tabella di carico - Load table - Tableau de charge - Belastbarkeitstabelle

**SPALLA**

Frame - Echelle - Rahmen

BASE NON ANCORATA Not fixed base / Base pas fixe / Nicht fixe Grundplatte		BASE ANCORATA Fixed base / Base fixe / Fixe Grundplatte	
h/mm	kg	h/mm	kg
200	6800	200	7100
500	6400	1000	6500
800	5800	2000	5400
1000	5000	2800	3000
1250	3800	3600	2000

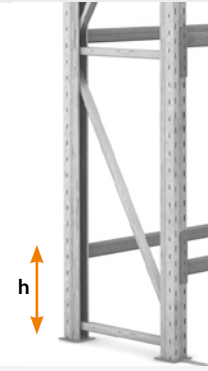

**CORRENTE**

Beam - Lisse - Längstraversen

kg/ paio - Pair - couple - Paar	Serie C60	Serie C80	Serie C100	Serie C120
↔1560 mm	1440 kg	2140 kg	2950 kg	3800 kg
↔1860 mm	1100 kg	1790 kg	2470 kg	3260 kg
↔2310 mm	700 kg	1410 kg	1980 kg	2610 kg
↔2790 mm	470 kg	960 kg	1630 kg	2160 kg

**CORRENTE A SEDIA "S"**

"S" shaped beam - Lisse à "S" - "S" förmige Längstraversen

kg/ paio - Pair - couple - Paar	Cod. C80
↔1560 mm	950 kg
↔1860 mm	800 kg
↔2310 mm	600 kg
↔2790 mm	500 kg

**PIANETTI**

Flat shelf - Platelage - Stahlpaneelen

SPESSORE - Thickness - Epaisseur - Dicke 7/10				
Corrente - Beam - Lisse - Längstraversen	Spalla - frame - Échelle - Rahmen 565 mm	Spalla - frame - Échelle - Rahmen 775 mm	Spalla - frame - Échelle - Rahmen 985 mm	Spalla - frame - Échelle - Rahmen 1165 mm
pcs/↔	10	12	15	17+1
↔1560 mm	1250 kg	1500 kg	1875 kg	2250 kg
↔1860 mm	850 kg	1020 kg	1275 kg	1530 kg
↔2310 mm	650 kg	780 kg	975 kg	1170 kg
↔2790 mm	550 kg	660 kg	825 kg	990 kg

**PIANETTI PER CORRENTE A SEDIA**

Flat shelf for "S" shaped beam - Platelage pour lisse à "S" - Stahlpaneelen "S" förmige Längstraversen

SPESSORE - Thickness - Epaisseur - Dicke 8/10		
Corrente - Beam - Lisse - Längstraversen	Spalla - frame - Échelle - Rahmen 985 mm	Spalla - frame - Échelle - Rahmen 1165 mm
pcs/↔	15	17+1
↔1560 mm	1875 kg	2250 kg
↔1860 mm	1275 kg	1530 kg
↔2310 mm	975 kg	1170 kg
↔2790 mm	825 kg	990 kg

Tabella di carico - Load table - Tableau de charge - Belastbarkeitstabelle

**CARICO**

Load - Charge - Belastung

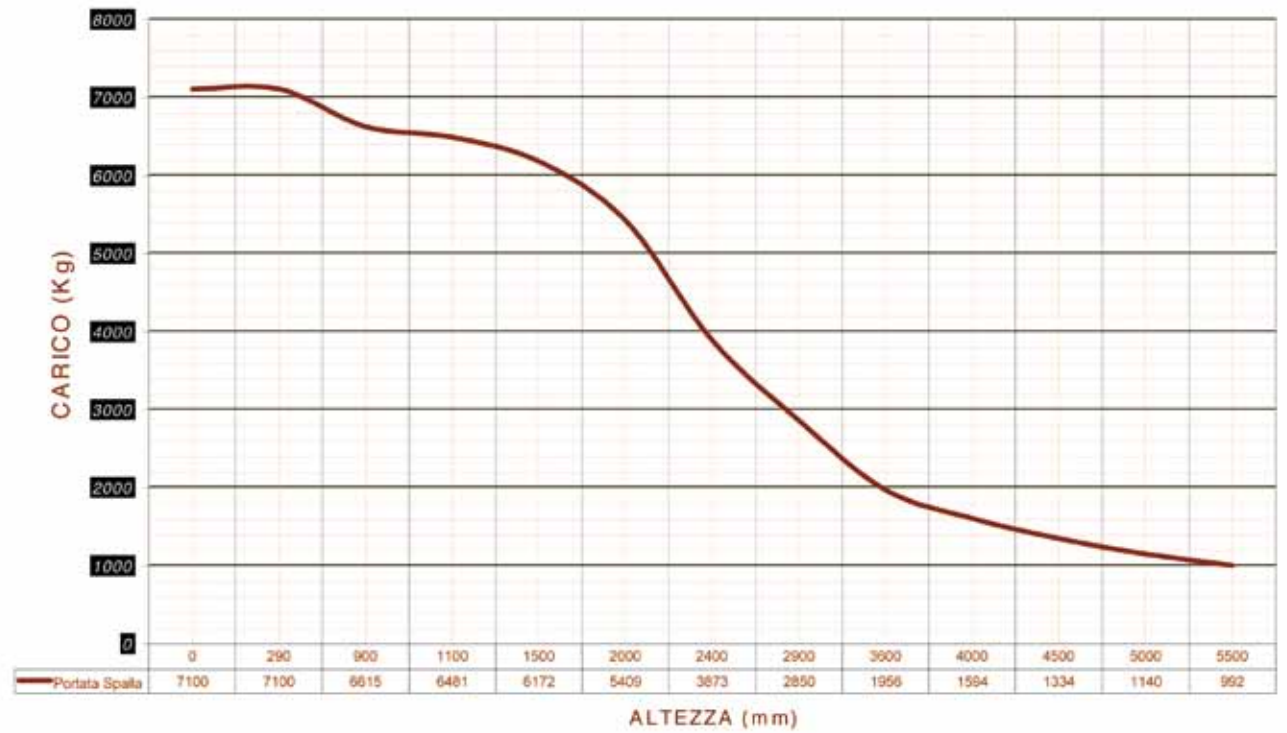

**CARICO**

Load - Charge - Belastbarkeit

8000 kg	4000 kg
7000 kg	3000 kg
6000 kg	2000 kg
5000 kg	1000 kg

**ALTEZZA 1° LIVELLO DI CARICO**

1st load level height - 1re niveau de charge - 1. Belastbarkeitsniveau

0 mm	2900 mm
290 mm	3600 mm
900 mm	4000 mm
1100 mm	4500 mm
1500 mm	5000 mm
2000 mm	5500 mm
2400 mm	



**SPALLA ZINCATA**

Galvanised frame - Echelle galvanisé - Verzinkte Rahmen

Cod.	XS200Z01	XS201Z01	XS202Z01	XS203Z01	XS204Z01	XS205Z01	XS206Z01	XS207Z01	XS208Z01
↓ H mm	2188	2638	3138	3588	4088	4538	5038	5488	5988
↔ P mm	475	475	475	475	475	475	475	475	475
kg	17,28	20,28	24,97	27,07	30,86	33,87	37,66	40,67	44,45

Cod.	XS211Z01	XS212Z01	XS213Z01	XS214Z01	XS215Z01	XS216Z01	XS217Z01	XS218Z01	XS219Z01
↓ H mm	2188	2638	3138	3588	4088	4538	5038	5488	5988
↔ P mm	565	565	565	565	565	565	565	565	565
kg	17,57	20,66	24,48	31,38	31,38	34,47	38,29	41,38	45,19

Cod.	XS222Z01	XS223Z01	XS224Z01	XS225Z01	XS226Z01	XS227Z01	XS228Z01	XS229Z01	XS230Z01
↓ H mm	2188	2638	3138	3588	4088	4538	5038	5488	5988
↔ P mm	775	775	775	775	775	775	775	775	775
kg	18,29	21,56	25,47	28,73	32,64	35,91	39,82	43,09	46,99

Cod.	XS233Z01	XS234Z01	XS235Z01	XS236Z01	XS237Z01	XS238Z01	XS239Z01	XS240Z01	XS241Z01
↓ H mm	2188	2638	3138	3588	4088	4538	5038	5488	5988
↔ P mm	985	985	985	985	985	985	985	985	985
kg	19,07	25,52	26,55	29,99	34,02	37,47	41,5	44,95	48,97

Cod.	XS244Z01	XS245Z01	XS246Z01	XS247Z01	XS248Z01	XS249Z01	XS250Z01	XS251Z01	XS252Z01
↓ H mm	2188	2638	3138	3588	4088	4538	5038	5488	5988
↔ P mm	1165	1165	1165	1165	1165	1165	1165	1165	1165
kg	19,76	23,36	27,51	31,1	35,25	38,85	43	46,6	50,74

**SPALLA VERNICIATA**

Painted frame - Echelle vernie - Lackierte Träger Rahmen

Cod.	XS200V01	XS201V01	XS202V01	XS203V01	XS204V01	XS205V01	XS206V01	XS207V01	XS208V01
↓ H mm	2188	2638	3138	3588	4088	4538	5038	5488	5988
↔ P mm	475	475	475	475	475	475	475	475	475
kg	17,71	20,8	24,69	27,79	31,68	34,77	38,67	41,76	45,65

Cod.	XS211V01	XS212V01	XS213V01	XS214V01	XS215V01	XS216V01	XS217V01	XS218V01	XS219V01
↓ H mm	2188	2638	3138	3588	4088	4538	5038	5488	5988
↔ P mm	565	565	565	565	565	565	565	565	565
kg	18,01	21,19	25,12	28,29	32,21	35,39	39,31	42,49	46,41

Cod.	XS222V01	XS223V01	XS224V01	XS225V01	XS226V01	XS227V01	XS228V01	XS229V01	XS230V01
↓ H mm	2188	2638	3138	3588	4088	4538	5038	5488	5988
↔ P mm	775	775	775	775	775	775	775	775	775
kg	18,76	22,12	26,13	29,49	33,51	36,87	40,89	44,25	48,27

Cod.	XS233V01	XS234V01	XS235V01	XS236V01	XS237V01	XS238V01	XS239V01	XS240V01	XS241V01
↓ H mm	2188	2638	3138	3588	4088	4538	5038	5488	5988
↔ P mm	985	985	985	985	985	985	985	985	985
kg	19,56	23,11	27,25	30,79	34,93	38,48	42,62	46,17	50,31

Cod.	XS244V01	XS245V01	XS246V01	XS247V01	XS248V01	XS249V01	XS250V01	XS251V01	XS252V01
↓ H mm	2188	2638	3138	3588	4088	4538	5038	5488	5988
↔ P mm	1165	1165	1165	1165	1165	1165	1165	1165	1165
kg	20,27	23,97	28,24	31,93	36,2	39,9	44,16	47,86	52,13

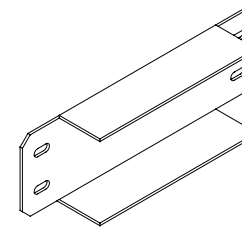
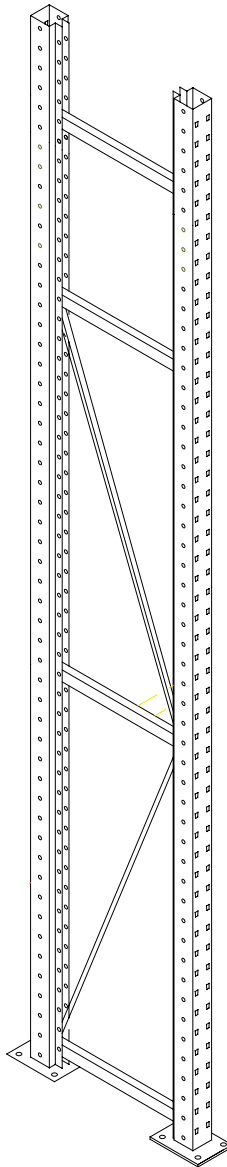

**DISTANZIATORE SPALLE ZINCATO**

Galvanised frame spacer  
Entretoise pour échelle  
Rahmenabstand

Cod.	XA018Z	XA012Z	XA013Z	XA014Z	XA015Z
↔ L mm	200	300	400	500	600

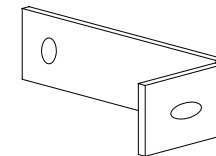

**DISTANZIATORE A MURO**

Wall spacer  
Entretoise à mur  
Wandabstand

Cod.	XA088V	XA089V	XA090V	XA091V	XA092V	XA093V	XA094V
↔ L mm	100	200	300	400	500	600	700

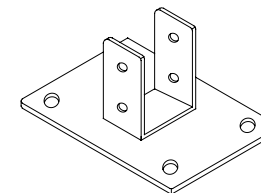

**PIASTRA DI BASE**

Base plate  
Plaque de base  
Grundplatte

Cod.	↔	↙	↕
XA060Z	110	4	140

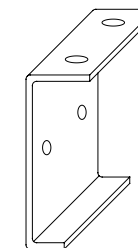

**SOSTEGNO ZINCATO OMEGA SPALLA**

Galvanised support omega/frame  
Support galvanisé omega/échelle  
Verzinktes Omega/Trägerhalterung

Cod.	↔	↙	↕
XA059Z	110	1,5	140

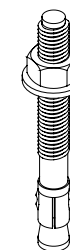

**TASSELLI AD ESPANSIONE**

Expansion anchors  
Chevilles à expansion  
Spreitzdübel

Cod.	↔	↙	↕
730030/nr	-	-	80
730010/nr	-	-	60

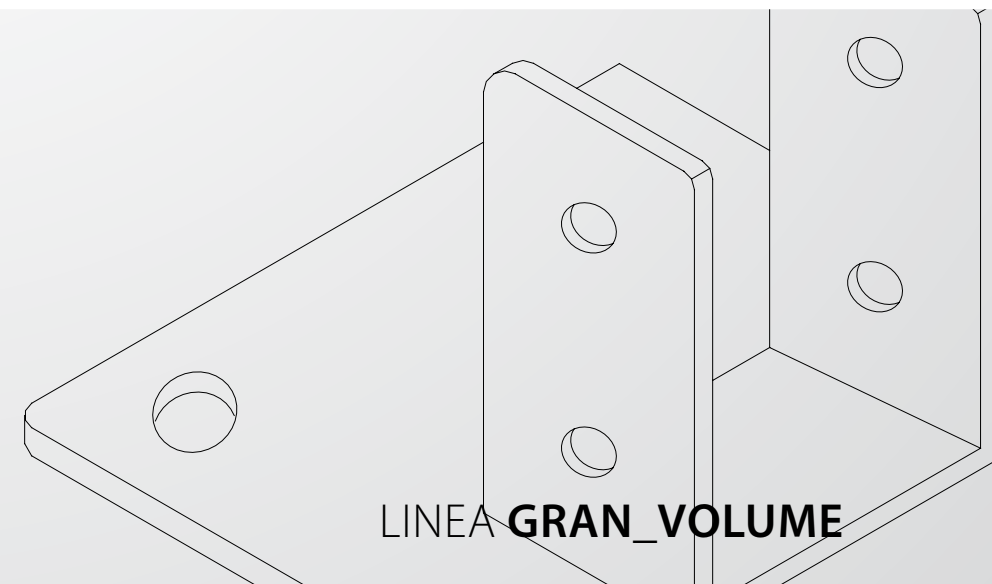





**SERIE CORRENTE**

Beam  
Lisse  
Traversen

**C60**

Cod.	↔	↙	↕	Kg
XC000V	1549	50	60	5,78
XC001V	1849	50	60	6,79
XC002V	2299	50	60	8,31
XC003V	2779	50	60	9,93

**C80**

Cod.	↔	↙	↕	Kg
XC004V	1549	50	80	6,73
XC005V	1849	50	80	7,93
XC006V	2299	50	80	9,74
XC007V	2779	50	80	11,67

**C100**

Cod.	↔	↙	↕	Kg
XC008V	1549	50	100	7,67
XC009V	1849	50	100	9,06
XC010V	2299	50	100	11,15
XC011V	2779	50	100	13,37

**C120**

Cod.	↔	↙	↕	Kg
XC012V	1549	50	120	8,63
XC013V	1849	50	120	10,22
XC014V	2299	50	120	12,58
XC015V	2779	50	120	15,24

**CORRENTE A SEDIA**

Stepped beam  
Lisse feuillure  
"S" förmige Traversen

**C80S**

Cod.	↔	↙	↕	Kg
XC019V	1560	40	80	6,00
XC020V	1860	40	80	7,05
XC021V	2310	40	80	8,63
XC022V	2790	40	80	10,32



**DISPOSITIVO ANTISGANCIO PER CORRENTI**

Safety locking pins for beam - Goupilles de sécurité pour lisse - Sicherungshacken für Traversen

Cod.
XA046Z

**CORRENTE PORTAPNEUMATICI**

Tyres holder beam  
Lisse porte pneu  
Räder- / Reifentraversen

Cod.	↔	↙	↕	Kg
XC034V	1560	30	60	3,58
XC025V	1860	30	60	5,00
XC036V	2310	30	60	4,15

**PARACOLPI**

Base protection  
Butoir  
Anfahrerschutz

Cod.	↔	↙	↕	Kg
SPP0007	205	5	300	5,20
SPP0008	769	5	455	19,22
SPP0009	859	5	455	21,00

Cod.	↔	↙	↕	Kg
SPP0010	1069	5	455	25,40
SPP0011	1279	5	455	29,70
SPP0012	1459	5	455	39,13





**PROFILO ZINCATO PORTAPIANETTI**

Galvanised flat shelf holder  
 Profil galvanisé pour support platelage  
 Verzinktes Profil für Fächerhalterung

Cod.	↔	con - with - avec - mit
XP005Z	1488	XC00V
XP006Z	1788	XC01V
XP007Z	2238	XC02V
XP008Z	2718	XC07V



**PIANETTI ZINCATI**

per correnti serie C da abbinare profilo zincato  
 Galvanised flat shelf to be combined with C series beams  
 Platelage galvanisé à coupler avec profil galvanisé  
 Verzinktes Flächen zum Kuplung mit Halterung

7/10

Cod.	↔	↙	↕	Kg
XP000Z	556	149	20	0,69
XP001Z	766	149	20	0,96
XP002Z	976	149	20	1,19
XP003Z	1156	149	20	1,45

**PIANETTI COMPENSATIVI**

per correnti serie C da abbinare profilo zincato  
 Compensating flat shelf to be combined with C series beams  
 Platelage compensatif à coupler avec profil galvanisé  
 Ausgleichendes Flächen zum Kuplung mit Halterung

7/10

Cod.	↔	↙	↕	Kg
XP010Z	556	180	20	1,05
XP011Z	766	180	20	1,52
XP012Z	976	180	20	1,94
XP013Z	1156	180	20	2,19

**PIANETTI SCANTONATI ZINCATI**

per correnti serie C  
 Galvanised cut shelf to be combined with C series beams  
 Platelage coupé à coupler avec profil galvanisé  
 Verzinktes geschnittene Flächen zum Kuplung mit Halterung

10/10

Cod.	↔	↙	↕	Kg
281234	565	149	30	1,10
281254	775	149	30	1,47
281264	985	149	30	1,54
281274	1156	149	30	1,74

**PIANETTI SCANTONATI COMPENSATIVI**

per correnti serie C da abbinare profilo zincato  
 Compensating cut flat shelf to be combined with C series beams  
 Platelage coupé compensatif à coupler avec profil galvanisé  
 Ausgleichendes geschnittenes Flächen zum Kuplung mit Halterung

10/10

Cod.	↔	↙	↕	Kg
XP031Z	565	180	30	1,23
XP032Z	775	180	30	1,66
XP033Z	985	180	30	2,09
XP034Z	1165	180	30	2,47

**PIANETTI ZINCATI**

per correnti a sedia serie C80S  
 Galvanised flat shelf to be combined with C80S series stepped beams  
 Platelage galvanisé à coupler avec lisse feuillure C80S  
 Verzinktes Flächen zum Kuplung mit C80S förmige Traversen

8/10

Cod.	↔	↙	↕	Kg
XP021Z	497	149	25	0,61
XP019Z	707	149	25	0,94
XP015Z	917	149	25	1,26
XP016Z	1097	149	25	1,51

**PIANETTI COMPENSATIVI ZINCATI**

per correnti a sedia serie C80S  
 Galvanised compensating flat shelf to be combined with C80S series stepped beams  
 Platelage compensatif galvanisé à coupler avec lisse feuillure C80S  
 Verzinktes ausgleichende Flächen zum Kuplung mit C80S förmige Traversen

8/10

Cod.	↔	↙	↕	Kg
XP022Z	556	180	20	1,05
XP020Z	766	180	20	1,52
XP017Z	976	180	20	1,94
XP018Z	1156	180	20	2,19

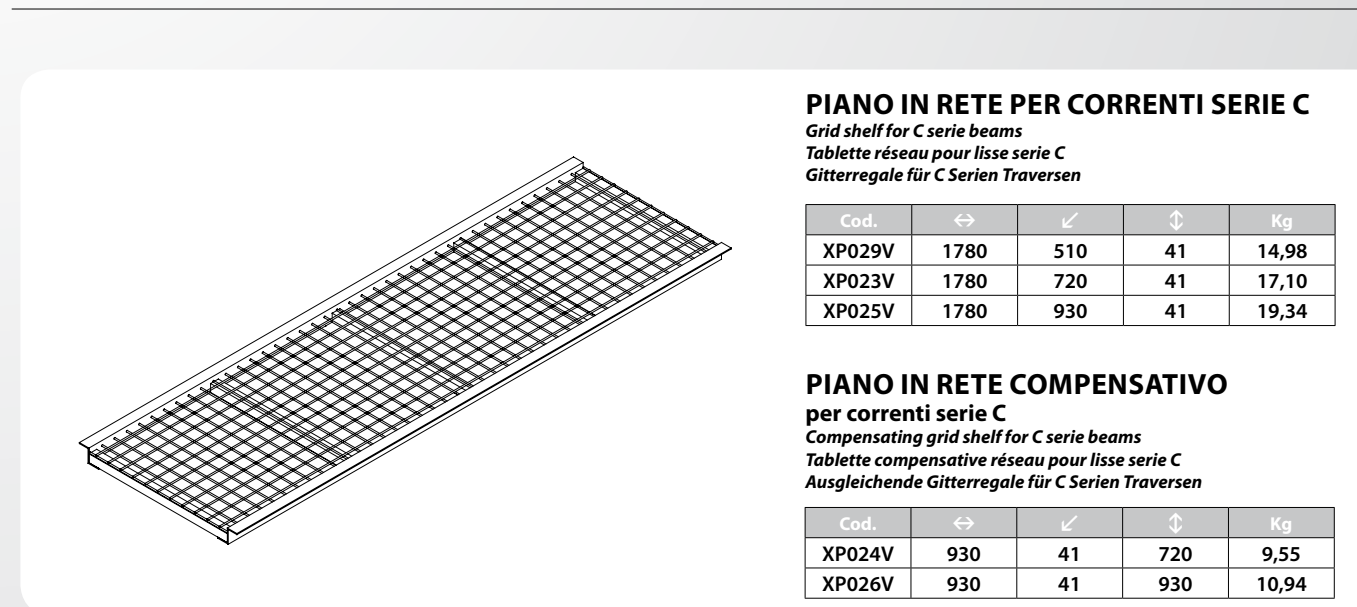
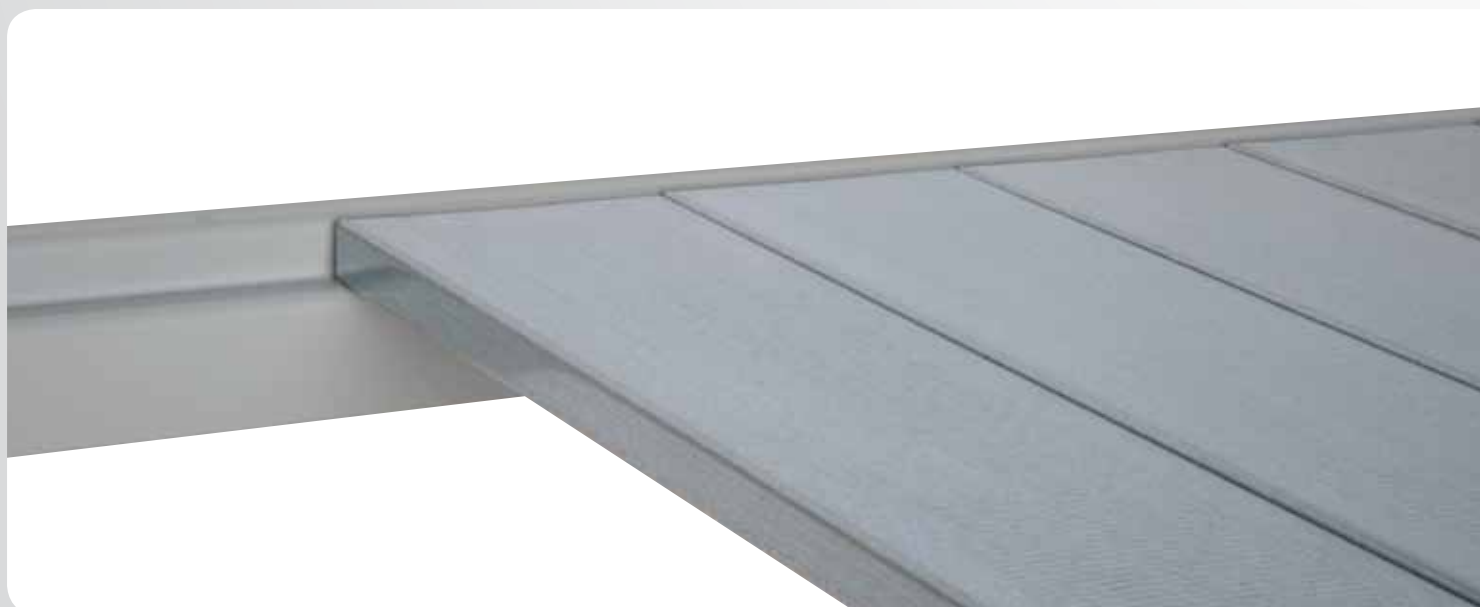

**PIANO IN RETE PER CORRENTI SERIE C**

Grid shelf for C serie beams  
 Tablette réseau pour lisse serie C  
 Gitterregale für C Serien Traversen

Cod.	↔	↙	↕	Kg
XP029V	1780	510	41	14,98
XP023V	1780	720	41	17,10
XP025V	1780	930	41	19,34

**PIANO IN RETE COMPENSATIVO**

per correnti serie C  
 Compensating grid shelf for C serie beams  
 Tablette compensative réseau pour lisse serie C  
 Ausgleichende Gitterregale für C Serien Traversen

Cod.	↔	↙	↕	Kg
XP024V	930	41	720	9,55
XP026V	930	41	930	10,94





**PANNELLO TRUCIOLARE**

*Chipboard - Panneaux à copeaux - Spanplatten*

Cod.	↔	↙	↕	C805 < 565 mm	Kg
XL000A	1488	497	22	1560	10,40
XL001A	1788	497	22	1860	12,50
XL002A	2238	497	22	2310	15,64
XL003A	2718	497	22	2790	19,00

Cod.	↔	↙	↕	C805 < 775 mm	Kg
XL004A	1488	707	22	1560	14,81
XL005A	1788	707	22	1860	17,79
XL006A	2238	707	22	2310	22,27
XL007A	2718	707	22	2790	27,04

Cod.	↔	↙	↕	C805 < 985 mm	Kg
XL008A	1488	917	22	1560	19,20
XL009A	1788	917	22	1860	0,94
XL010A	2238	917	22	2310	1,26
XL011A	2718	917	22	2790	1,51

Cod.	↔	↙	↕	C805 < 1165 mm	Kg
XL012A	1488	1097	22	1560	0,61
XL013A	1788	1097	22	1860	0,94
XL014A	2238	1097	22	2310	1,26
XL015A	2718	1097	22	2790	1,51

**FERMO ZINCATO PER PIANO TRUCIOLARE**

*Galvanised stop for chipboard  
Stopper pour panneaux à copeaux  
Spanplattenhalterung*

Cod.	↔	↙	↕	Kg
XA056Z	300	1,5	140	-



LINEA **GRAN\_VOLUME**

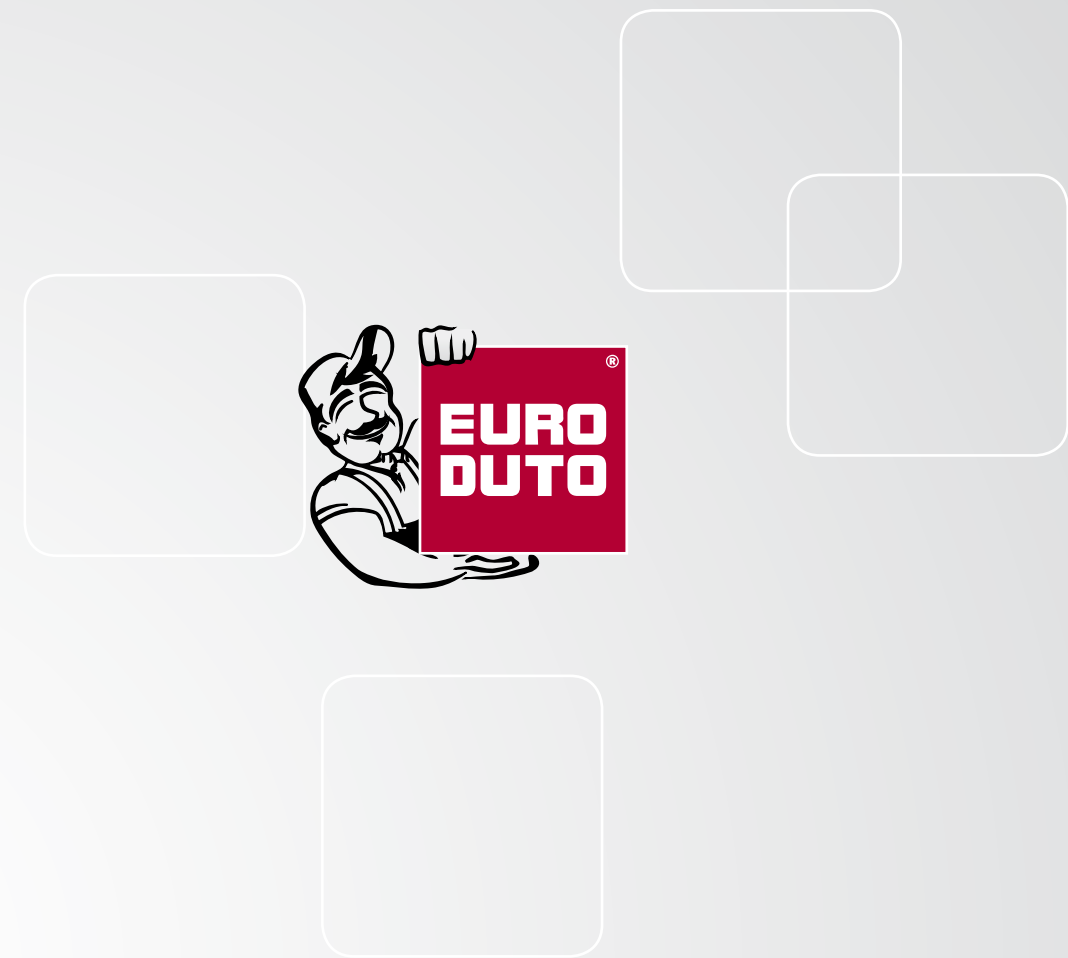

**La Rigenerazione del Magazzino**  
The Storing System Regeneration



LINEA **GRAN\_VOLUME**