



STORAGE_EURODUTO



LINEA
PRATIC_LEVEL



ogni giorno più di
1.000.000 km di scaffali
tengono in ordine
i vostri prodotti

40°
1973 - 2011

every day more than a
1.000.000 km shelving
systems maintain your
products in order

FASCIA DI CONTROVENTATURA
Top brace
Controventement
Trägerverbindung



SCALA A AGGANCI
Hanging stair
Echelle à crochet
Einhängbare Regalleiter

FASCIA SALVAPIEDE
Kick board
Plinthes aux pieds
Trittschutz



RINGHIERA
Hand-rail
Rambarde
Geländer



STAFFA PROLUNGABILE
Extendable support
Support extensible
Verlängerungsbügel

6

LINEA
PRATIC_LEVEL

7

SOSTEGNO
Walk-on support
Soutèment
Laufstegträger



MONTANTE BIFRONTI
Double sided uprights
Montant bifrontal
Zweiseitige Träger



TAPPO A SOFFITTO
per montanti mono-/bifronti
CEILING LOCKER
for one-double sided uprights
VERIN D'ANCRAGE
pour montant mono-et
bifrontal au plafond
DECKENVERANKERUNG
für ein-, und zweiseitige Träger

**PAVIMENTO
MODULARE**
Modular slats
Plancher modulaire
Modulbühnenbelag



FASCIA DI COLLEGAMENTO
Uprights connection
Connexion montant
Längsträgerverbindung



**PIEDE DI SOSTEGNO
TRIANGOLARE**
Triangular base plates
Dreieckiger Fuss
Pied triangulare



SCALA A RAMPA UNICA
Single stairs module
Escalier singule
Einzelrampen Treppe

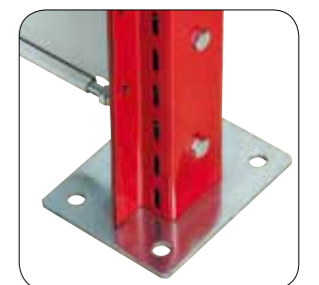

PIEDE DI SOSTEGNO
Base plates
Plaques de base
Grundplatte



MONTANTE MONOFRONTA
One sided uprights
Montant monofrontal
Einseitiger Träger

| Cod. |
|-----------|
| 111013/mt |



MONTANTE BIFRONTA
Double sided uprights
Montant bifrontal
Zweiseitiger Träger

| Cod. |
|-----------|
| 101023/mt |

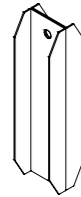

INNESTO SOPRAELEVAZIONI MONTANTE BIFRONTA
Overfloor connection double sided uprights
Manchon baionette
Überbauanschluß zweiseitige Träger

| Cod. | ↔ | ↙ | ↕ |
|-----------|----|----|-----|
| 101553/nr | 53 | 49 | 60 |
| 101463/nr | 53 | 49 | 125 |
| 101443/nr | 53 | 49 | 250 |
| 101453/nr | 53 | 49 | 250 |

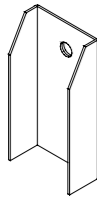

INNESTO SOPRAELEVAZIONI MONTANTE MONOFRONTA
Overfloor connection one sided upright
Manchon baionette
Überbauanschluß einseitige Träger

| Cod. | ↔ | ↙ | ↕ |
|-----------|----|----|-----|
| 101223/nr | 53 | 24 | 125 |
| 101233/nr | 53 | 24 | 250 |

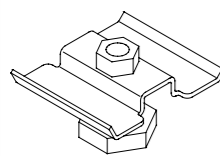

PIEDINO REGOLABILE COMPLETO
Adjustable complete support
Embase réglable complète
Komplett Stellfuß

| Cod. | ↔ | ↙ | ↕ |
|-----------|-----|----|-----|
| 113693/nr | 120 | 65 | 130 |

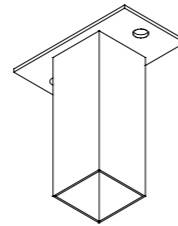

INNESTO TUBOLARE FISSAGGIO MONTANTE/SOFFITTO
Tubing connection double sided uprights
Manchon à tube
Rohranschluß zweiseitige Träger

| Cod. | ↔ | ↙ | ↕ |
|-----------|-----|----|-----|
| 101433/nr | 120 | 65 | 130 |

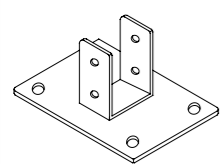

PIASTRA DI BASE MONTANTE BIFRONTA
Base plates double sided uprights
Plaque de base montant bifrontal
Grundplatte zweiseitige Träger

| Cod. | ↔ | ↙ | ↕ |
|-----------|-----|-----|---|
| XA060Z/nr | 110 | 140 | 4 |

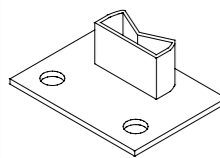

PIASTRA DI BASE MONTANTE MONOFRONTA
Base plate one sided uprights
Plaque de base montant monofrontal
Grundplatte einseitige Träger

| Cod. | ↔ | ↙ | ↕ |
|-----------|-----|----|---|
| 111163/nr | 100 | 60 | 2 |

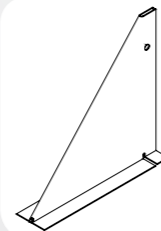

PIEDE DI SOSTEGNO
Embase triangulaire
Triangular support
Stützfuß

| Cod. | ↔ | ↙ | ↕ |
|-----------|---|-----|---|
| 101053/nr | - | 250 | - |
| 111063/nr | - | 490 | - |

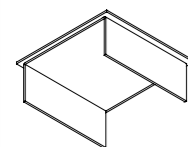

CHIUSINO MONTANTE BIFRONTA
Top cover double sided uprights
Couvercle supérieur montant bifrontal
Top-Verschluß zweiseitige Träger

| Cod. | ↔ | ↙ | ↕ |
|-----------|----|----|---|
| 101113/nr | 30 | 57 | - |

CHIUSINO MONTANTE MONOFRONTA
Top cover one sided uprights
Couvercle supérieur montant monofrontal
Top-Verschluß einseitige Träger

| Cod. | ↔ | ↙ | ↕ |
|-----------|----|----|---|
| 111083/nr | 55 | 57 | - |

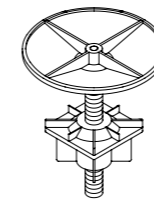

TAPPO A SOFFITTO MONTANTE BIFRONTA
Vérin d'ancrage au plafond montant bifrontal
Ceiling ties double sided uprights
Deckenverankerung - zweiseitige Träger

| Cod. | ↔ | ↙ | ↕ |
|-----------|----|---|-----|
| 101044/nr | 85 | - | 110 |
| 101494/nr | 85 | - | 210 |

TAPPO A SOFFITTO MONTANTE MONOFRONTA
Vérin d'ancrage au plafond montant monofrontal
Ceiling ties one sided uprights
Deckenverankerung - einseitige Träger

| Cod. | ↔ | ↙ | ↕ |
|-----------|----|---|-----|
| 111034/nr | 85 | - | 110 |
| 111094/nr | 85 | - | 210 |

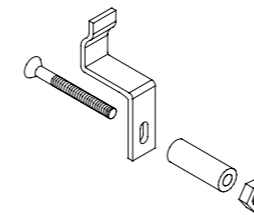

KIT FISSAGGIO MONTANTE MONOFRONTA
Anchor bolts one sided uprights
Cheville d'ancrage montant monofrontal
Wandverankerung einseitige Träger

| Cod. | ↔ | ↙ | ↕ |
|-----------|----|---|----|
| 111124/nr | 26 | - | 15 |

KIT FISSAGGIO MONTANTE BIFRONTA
Anchor bolts double sided uprights
Cheville d'ancrage montant bifrontal
Wandverankerung zweiseitige Träger

| Cod. | ↔ | ↙ | ↕ |
|-----------|----|---|----|
| 101134/nr | 73 | - | 15 |

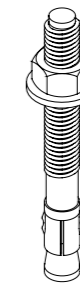

TASSELLI AD ESPANSIONE
Expansion anchors
Chevilles à expansion
Spreitzdübel

| Cod. | ↔ | ↙ | ↕ |
|-----------|-----|---|---|
| 730010/nr | 60 | - | - |
| 730030/nr | 80 | - | - |
| 730035/nr | 100 | - | - |

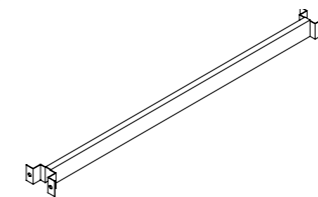

FASCIA DI COLLEGAMENTO SAGOMATA
Formed connection
Connexion formé
Förmige Längsträgerverband

| Cod. | ↔ | ↙ | ↕ |
|-----------|-----|---|----|
| 102004/nr | 926 | - | 53 |
| 102003/nr | 926 | - | 53 |

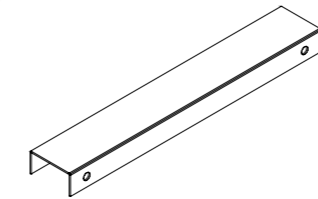

FASCIA DI CONTROVENTATURA LONGITUDINALE
Lengthwise top brace
Contrement longitudinal
Trägerverbindung

| Cod. | ↔ | ↙ | ↕ |
|-----------|----|----|---|
| 101143/mt | 62 | 30 | - |

FASCIA DI CONTROVENTATURA TRASVERSALE
Cross top brace
Contrement trasversal
Querträgerverbindung

| Cod. | ↔ | ↙ | ↕ |
|-----------|----|----|---|
| 101743/mt | 20 | 50 | - |

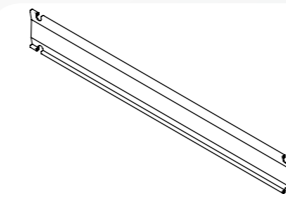

FASCIA DI COLLEGAMENTO MONTANTE MONOFRONTA - BIFRONTA
One-double sided upright connection
Connexion montant mono-bifrontal
Ein-, zweiseitiger Träger Längsverband

| Cod. | ↔ | ↙ | ↕ |
|-----------|-----|---|-----|
| 101153/nr | 872 | - | 151 |

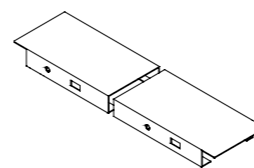

PAVIMENTO METTALICO CHIUSO
Plain metallic floor
Plancher module plein
Bühnenbelagstahlplatte aus Metall

| Cod. | ↔ |
|-----------|-------------------|
| 111344/mq | 150 20/10 zincata |
| 101564/mq | 150 15/10 zincata |

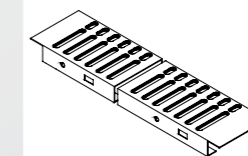

PAVIMENTO METTALICO GRIGLIATO
Punched metallic floor
Plancher module grillagé
Bühnenbelagstahlplatte aus Metall

| Cod. | ↔ |
|-----------|-------------------|
| 101804/mq | 150 15/10 zincata |

PROFILO OMEGA
Omega profile
Profil oméga
Omega Profil

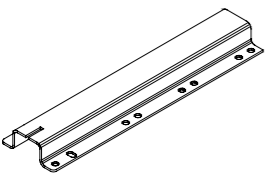

| Cod. | ↕ |
|-----------|----|
| 101283/mt | 37 |

PROFILO AD OMEGA RINFORZATO
Reinforced omega profile
Profil oméga renforcé
Verstärktes Omega Profil

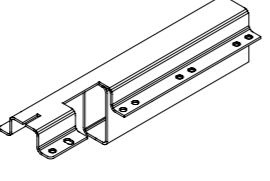

| Cod. | ↕ |
|-----------|-----|
| 101313/mt | 63 |
| 101523/mt | 103 |
| 101533/mt | 153 |

SQUADRA A MURO PER SOSTEGNO OMEGA
Omega support plate
Plaque de support omega
Winkeleisen Unterstützung

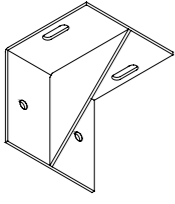

| Cod. | ↔ | ↙ | ↕ |
|-----------|-----|-----|-----|
| 101233/nr | 110 | 100 | 100 |

SOSTEGNO DOPPIO ZINCATO
Double galvanised support
Support double galvanisé
Verzinkte Doppelhalterung

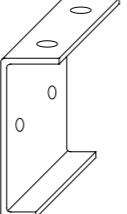

| Cod. |
|-----------|
| XA059Z/nr |

SQUADRA A MURO PER SOSTEGNO BALLATOIO
Wall walk on surface support
Plaque de support plancher
Wandbühnenbelagshalterung

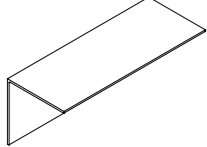

| Cod. | ↔ | ↙ | ↕ |
|-----------|-----|-----|-----|
| 111603/nr | 60 | 100 | 100 |
| 111613/nr | 100 | 100 | 100 |
| 111623/nr | 150 | 100 | 100 |
| 111633/nr | 200 | 100 | 100 |
| 111643/nr | 250 | 100 | 100 |
| 111653/nr | 300 | 100 | 100 |
| 111663/nr | 350 | 100 | 100 |
| 111673/nr | 400 | 100 | 100 |
| 111683/nr | 450 | 100 | 100 |
| 111693/nr | 500 | 100 | 100 |

SOSTEGNO OMEGA
Omega support
Support omega
Omega halterung



SEMPLICE ZINCATO
Galvanised simple
Galvanisé
Verzinkt

| Cod. |
|-----------|
| 101263/nr |

INIZIALE/FINALE MONTANTE BIFRONTE
Starting/ending double sided uprights
Initial/final montant bifrontal
Zweiseitiger Träger Start/Endseite

| Cod. |
|-----------|
| 101253/nr |

DOPPIO ZINCATO MONTANTE BIFRONTE
Double galvanised double sided uprights
Double galvanisé montant bifrontal
Doppelverzinkter zweiseitiger Träger

| Cod. |
|-----------|
| 101273/nr |

SCALA SMONTABILE RAMPA UNICA
Removable single ramp stairs
Escalier démontable à une seule rampe
Demontierbare Einzelrampen Treppe

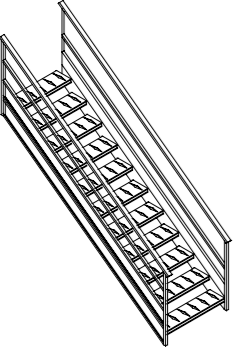

Cod. 102413/nr P: 2500mm H:3137mm hb=2080 mm
Cod. 102423/nr P: 2750mm H:3287 mm hb=2230mm
Cod. 102433/nr P: 2750mm H:3387mm hb=2330 mm
Cod. 102443/nr P: 3000mm H:3487mm hb=2430 mm
Cod. 102453/nr P: 3000mm H:3587mm hb=2530 mm
Cod. 102463/nr P: 3250mm H:3737mm hb=2680 mm
Cod. 102473/nr P: 3500mm H:3937mm hb=2880 mm
Cod. 102483/nr P: 3750mm H:4037mm hb=2980 mm

OMEGA LATERALE PER PASSERELLA IN SOSPENSIONE
Sided omega supporting suspended footbridge
Oméga latérale pour passerelle suspendue
Seitliches Omega Profil für Hängelaufsteg

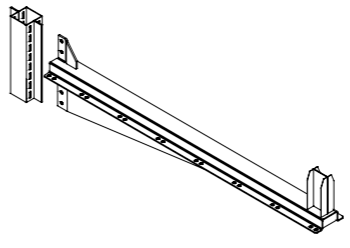

| Cod. | ↔ | ↙ | ↕ |
|-----------|---|------|---|
| 101503/nr | - | 1020 | - |

OMEGAFRONTALE PER PASSERELLA IN SOSPENSIONE
Front omega supporting suspended footbridge
Oméga frontale pour passerelle suspendue
Front Omega Profil für Hängelaufsteg

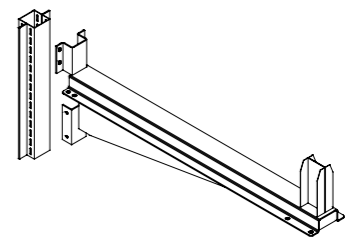

| Cod. | ↔ | ↙ | ↕ |
|-----------|---|-----|---|
| 101513/nr | - | 930 | - |

RINFORZO GRADINO SCALA SMONTABILE
Step reinforcement - removable stairs
Reforcement pour marche d'escalier démontable
Schrittverstärkung - abnehmbare Stufen

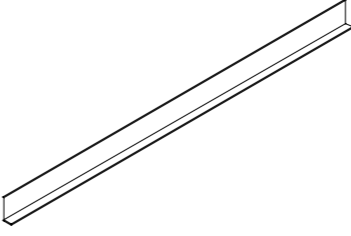

| Cod. | ↔ | ↙ | ↕ |
|-----------|-----|----|----|
| 111734/nr | 930 | 20 | 55 |

TUBO RINGHIERA
Railing tube
Tube balustrade
Rohrgeländer

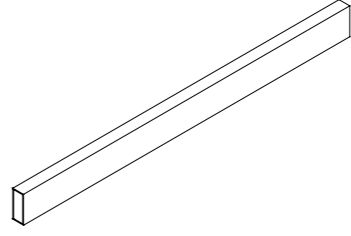

| Cod. | ↔ | ↙ | ↕ |
|-----------|---|----|----|
| 101393/mt | - | 20 | 50 |

CORRIMANO ALLUMINIO
Aluminum handrail
Rampe en aluminium
Handlaufrohr



| Cod. | ↔ | ↙ | ↕ |
|-----------|---|----|----|
| 111498/mt | - | 60 | 40 |

FASCIA SALVAPIEDE
Kickboard
Plinthes aux pieds
Trittschutz

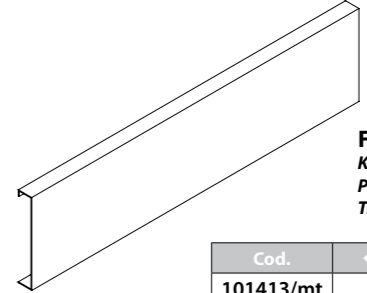

| Cod. | ↔ | ↙ | ↕ |
|-----------|---|----|-----|
| 101413/mt | - | 25 | 150 |

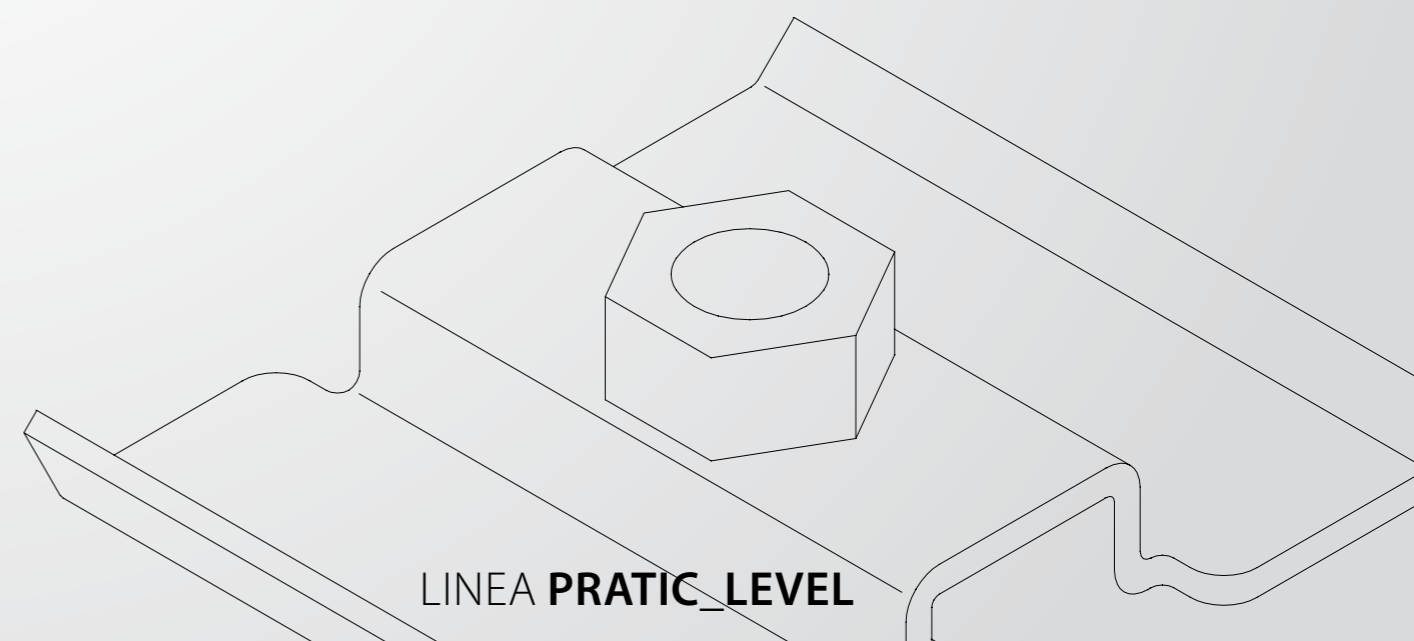

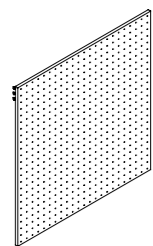

PANNELLO FORATO AD AGGANCIAMENTO - NO PIANI

*Hanging punched panel - no shelves
Panneau perforé suspendu - pas tablettes
Lochpanel zum einhaken - kein Regal*

| Cod. | ↔ | ↙ | ↕ | Kg |
|-----------|-----|----|-----|------|
| 112353/nr | 905 | 22 | 445 | 3,49 |
| 112343/nr | 905 | 22 | 958 | 6,86 |

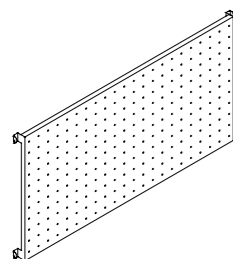

PANNELLO FORATO AD AGGANCIAMENTO PER MONTANTE BIFRONTI PIANI INCLUSI

*Hanging punched panel for double sided uprights- shelves assembling
Panneau perforé suspendu pour montant bifrontal - tablettes montable
Zweiseitige Träger Lochpanel zum einhaken - Regale zum Abbau*

| Cod. | ↔ | ↙ | ↕ | Kg |
|-----------|-----|---|-----|------|
| 112703/nr | 875 | - | 446 | 3,25 |

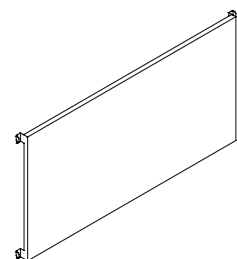

PANNELLO IN LAMIERA CHIUSA AD AGGANCIAMENTO PER MONTANTE BIFRONTI PIANI INCLUSI

*Hanging plain panel for double sided uprights- shelves assembling
Panneau suspendu pour montant bifrontal - tablettes montable
Zweiseitige Träger Panel zum einhaken - Regale zum Abbau*

| Cod. | ↔ | ↙ | ↕ | Kg |
|-----------|-----|---|-----|------|
| 112713/nr | 875 | - | 446 | 3,65 |

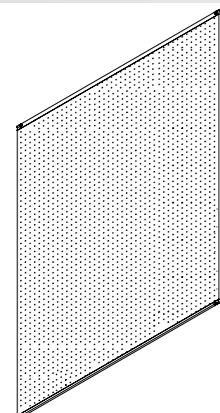

PANNELLO IN LAMIERA FORATA AD AGGANCIAMENTO CON FASCIA DI COLLEGAMENTO SI AGGANCIAMENTO PIANI

*Hanging punched panel with uprights connection- shelves assembling
Panneau perforé suspendu avec connexion montant - tablettes montable
Trägeranschluß Lochpanel zum einhaken - Regale zum Abbau*

| Cod. | ↕ | Kg |
|-----------|-----------|-------|
| 140093/mq | max. 2053 | 9,30 |
| 115353/nr | 1056 | 7,82 |
| 115363/nr | 1312 | 9,46 |
| 115373/nr | 1632 | 11,50 |
| 115383/nr | 1920 | 13,34 |

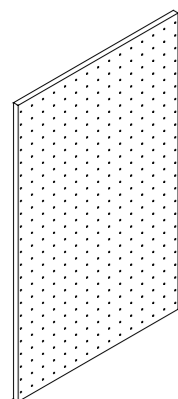

PANNELLO FORATO AD AGGANCIAMENTO FRONTALE - NO PIANI

*Hanging front punched panel - no shelves
Panneau frontal perforé suspendu - pas tablettes
Lochpanel zum front Haken - kein Regal*

| Cod. | ↔ | ↙ | ↕ | Kg |
|-----------|-----|---|------|------|
| 112753/nr | 930 | - | 580 | 4,32 |
| 112763/nr | 930 | - | 820 | 6,64 |
| 112773/nr | 930 | - | 1020 | 8,06 |

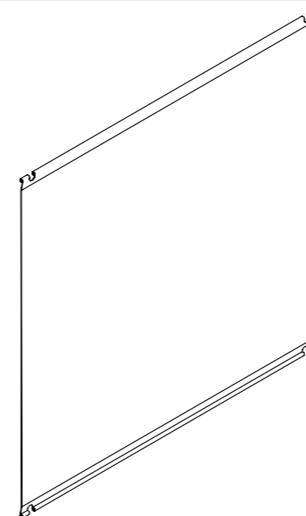

PANNELLO IN LAMIERA CHIUSA AD AGGANCIAMENTO CON FASCIA DI COLLEGAMENTO SI AGGANCIAMENTO PIANI

*Hanging plain panel with uprights connection- shelves assembling
Panneau suspendue avec connexion montant - tablettes montable
Trägeranschlußwand zum einhaken - Regale zum Abbau*

| Cod. | ↔ | ↙ | ↕ | Kg |
|-----------|------|---|---|-------|
| 113633/mq | 2053 | - | - | 9,50 |
| 115313/nr | 1056 | - | - | 8,71 |
| 115323/nr | 1312 | - | - | 10,58 |
| 115333/nr | 1632 | - | - | 12,91 |
| 115343/nr | 1920 | - | - | 15,08 |

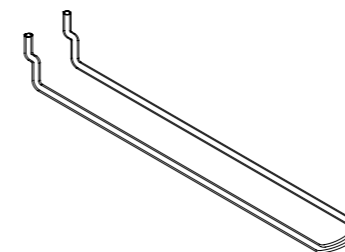

GANCIO DOPPIO

*Double hook
Double crochet
Doppelhaken*

| Cod. | ↔ | ↙ | ↕ | Kg |
|-----------|-----|---|---|------|
| 210060/nr | 100 | - | - | 0,03 |
| 210061/nr | 150 | - | - | 0,03 |
| 210026/nr | 200 | - | - | 0,04 |

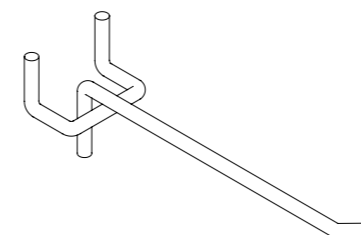

GANCIO DRITTO

*Straight hook
Crochet droit
Gerade Hacken*

| Cod. | ↔ | ↙ | ↕ | Kg |
|-----------|-----|---|---|------|
| 210021/nr | 50 | - | - | 0,01 |
| 210022/nr | 100 | - | - | 0,02 |
| 210023/nr | 150 | - | - | 0,02 |
| 210024/nr | 200 | - | - | 0,02 |

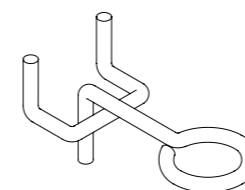

GANCIO ROTONDO

*Round hook
Crochet rond
Rundhaken*

| Cod. | ↔ | ↙ | ↕ | Kg |
|-----------|----|---|---|------|
| 210025/nr | 50 | - | - | 0,02 |

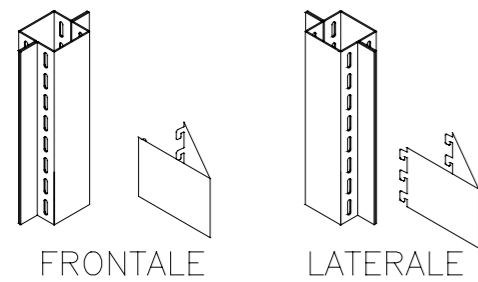

INDICATORE DI DIREZIONE
Way indicator
Indicateur de chemin
Wegindikator

| Cod. | ↔ | ↙ | ↕ | Kg |
|-----------|---|---|---|------|
| 112483/nr | - | - | - | 0,17 |
| 112493/nr | - | - | - | 0,17 |

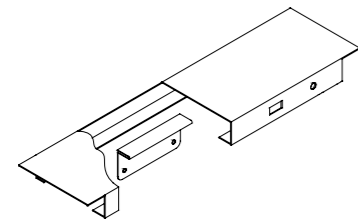

INDICATORE CENTRALE DI DIREZIONE A PAVIMENTO
Floor way indicator
Indicateur de chemin sur sol
Bodenwegindikator

| Cod. | ↔ | ↙ | ↕ | Kg |
|-----------|-----|---|----|------|
| 101873/nr | 100 | - | 90 | 0,14 |

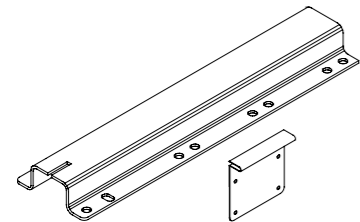

INDICATORE CENTRALE DI DIREZIONE OMEGA
Omega way indicator
Indicateur de chemin pour omega
Omegawegindikator

| Cod. | ↔ | ↙ | ↕ | Kg |
|-----------|-----|---|----|------|
| 101883/nr | 100 | - | 90 | 0,14 |

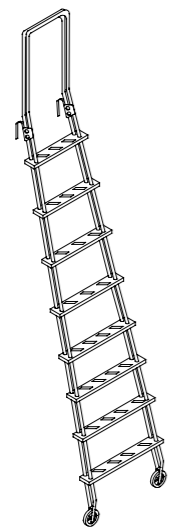

SCALA SEMPLICE IN ACCIAIO INOX AD AGGANCIAMENTO
Simple stainless steel stairs - hooking system
Échelle simple en acier inoxydable - système accrochage
Einhängbare Regalleiter

| Cod. | ↔ | ↙ | ↕ | Kg |
|-----------|---|---|------|-------|
| SS000Z/nr | - | - | 2500 | 8,68 |
| SS001Z/nr | - | - | 2750 | 8,88 |
| SS002Z/nr | - | - | 3000 | 10,68 |
| SS003Z/nr | - | - | 3250 | 11,68 |
| SS004Z/nr | - | - | 3500 | 12,68 |

STAFFA PROLUNGABILE
Adjustable support
Support extensible
Erweiterbarer Bügel

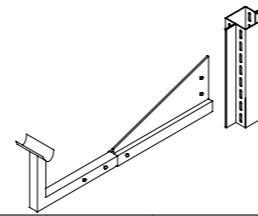

COD. SS000Z-SS004Z

| Cod. | ↔ | ↙ | ↕ | Kg |
|-----------|-----------|---|---|------|
| 136534/nr | 380 - 555 | - | - | 1,25 |

TUBO PER STAFFA
Tube for
Tube pour
Rohr für Bügel

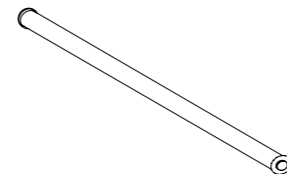

COD. 136534

| Cod. | ↔ | ↙ | ↕ | Kg |
|-----------|---|---|---|------|
| 730156/nr | coppia terminali/tube caps/ tube couvercles/Rohrverschluß | | | |
| 102224/nr | 930 | - | - | 0,80 |
| 102264/nr | 1030 | - | - | 0,89 |
| 102234/nr | 1860 | - | - | 1,60 |
| 102274/nr | 2060 | - | - | 1,78 |
| 102244/nr | 2790 | - | - | 2,40 |
| 102284/nr | 3090 | - | - | 2,66 |

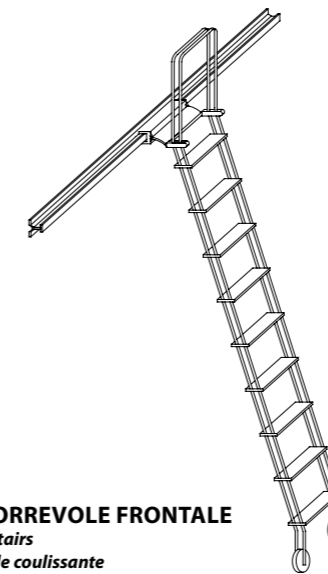

SCALA SCORREVOLE FRONTALE
Front sliding stairs
Échelle frontale coulissante
Verschiebbare Regalleiter

| Cod. | ↔ | ↙ | ↕ | Kg |
|-----------|---|---|------|----|
| 201144/nr | - | - | 2500 | 8 |
| 201144/nr | - | - | 2750 | 10 |
| 201146/nr | - | - | 3000 | 12 |
| 201147/nr | - | - | 3250 | 14 |
| 201148/nr | - | - | 3500 | 16 |
| 201149/nr | - | - | 3750 | 18 |

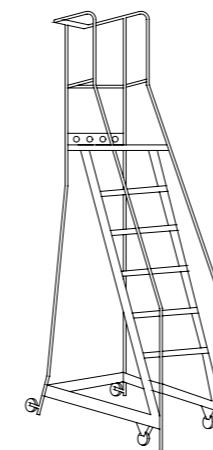

SCALA A PALCHETTO IN ACCIAIO INOX E ALLUMINIO
Stainless steel and aluminum box stairs
Escaroul en aluminium et acier
Stahlblech- und Aluminium Stufenstehtleiter

| Cod. | ↔ | ↙ | ↕ | Kg |
|-----------|-----|------|------|----|
| 201167/nr | 620 | 1050 | 2250 | 31 |
| 201168/nr | 650 | 1200 | 2500 | 34 |
| 201169/nr | 680 | 1300 | 2750 | 37 |
| 201170/nr | 710 | 1450 | 3000 | 40 |
| 201171/nr | 740 | 1600 | 3250 | 44 |
| 201172/nr | 770 | 1720 | 3500 | 48 |
| 201173/nr | 800 | 1850 | 3750 | 52 |
| 201174/nr | 830 | 1980 | 4000 | 56 |
| 201175/nr | 860 | 2120 | 4250 | 60 |

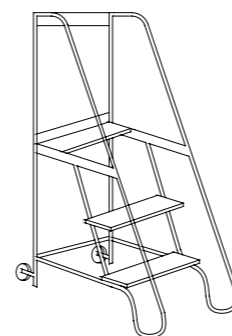

SCALA SGABELLO ACCIAIO INOX E ALLUMINIO
Aluminum and stainless stool stairs
Échelle plate-forme individuel en acier et aluminium
Stahlblech und Aluminium Podestleiter

| Cod. | ↔ | ↙ | ↕ | Kg |
|-----------|-----|---|------|----|
| 201164/nr | 510 | - | 1120 | 16 |
| 201165/nr | 530 | - | 1360 | 19 |
| 201163/nr | 550 | - | 1600 | 21 |

STAFFA PROLUNGABILE
Adjustable support
Support extensible
Verlängerungsbügel

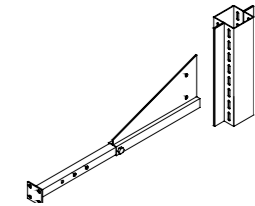

COD. 201144-201149

| Cod. | ↔ | ↙ | ↕ | Kg |
|-----------|-----------|---|---|------|
| 102044/nr | 380 - 555 | - | - | 1,06 |

BINARIO PER
Rail for
Rail pour
Schiene für

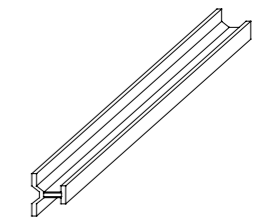

COD. 201144-201149

| Cod. | |
|--------------|---|
| 730148/nr | Fermo rotaia / Stop rail / Rack stop / Schienen stop |
| 201135/mt | Binario / Rail / Rail / Schiene |
| 201136/nr | Curva 90° / 90° bend / Courbe 90° / 90° Bogen |
| 201137/nr | Giunzione / Verbindung ↔ 120 ↙ 5 ↘ 25 |
| 201138FEP/nr | Curva esterna / External bend / Courbe externe / externer Bogen |

PANNELLATURA IN RETE - MAGLIA*Net panel - mesh / Panneaux en filet - maille / Gitterpanel - Masche*

| Cod. | ↔ | ↙ | ↕ | Kg |
|-----------|----|----|---|------|
| 111403/mq | 40 | 40 | 4 | 5,23 |

TELAIO DI CHIUSURA IN RETE - MAGLIA*Net panel frame - mesh / Chassis en filet - maille / Gitterrahmen - Masche*

| Cod. | ↔ | ↙ | ↕ | Kg |
|-----------|----|----|---|------|
| 111433/mq | 40 | 40 | 4 | 9,33 |

TELAIO IN LAMIERA CHIUSA*Plain steel frame / Panneaux en métal / Stahlblechpanel*

| Cod. | ↔ | ↙ | ↕ | Kg |
|-----------|---|---|---|-------|
| 111513/mq | - | - | - | 12,43 |

TELAIO IN LAMIERA FORATA*Net steel frame / Chassis panneaux percés / Gitterrahmenpanel*

| Cod. | ↔ | ↙ | ↕ | Kg |
|-----------|---|---|---|------|
| 111423/mq | - | - | - | 5,35 |

TELAIO IN RETE E LAMIERA CHIUSA*Half net steel and half plain steel frame / Chassis moitié filet et moitié panneaux / Halb-gitter und Blechpanel*

| Cod. | ↔ | ↙ | ↕ | Kg |
|-----------|---|---|---|-------|
| 111393/mq | - | - | - | 12,46 |

**PORTA IN RETE***Grid door - Porte en grille - Gittertür*

| Cod. | ↔ | ↙ | ↕ | Kg |
|-----------|------|---|------|-------|
| 102323/nr | 805 | - | 2000 | 27,31 |
| 102343/nr | 1200 | - | 2000 | 33,22 |

PORTA IN LAMIERA CHIUSA*Plain steel door - Porte en métal - Blechtür*

| Cod. | ↔ | ↙ | ↕ | Kg |
|-----------|------|---|------|-------|
| 102383/nr | 805 | - | 2000 | 31,17 |
| 102403/nr | 1200 | - | 2000 | 39,00 |

PORTA RETE/LAMIERA CHIUSA*plain steel/grid combined door - porte en métal grille- Blech- Gittertür*

| Cod. | ↔ | ↙ | ↕ | Kg |
|-----------|------|---|------|-------|
| 102353/nr | 805 | - | 2000 | 29,21 |
| 102373/nr | 1200 | - | 2000 | 36,08 |

PORTA 2 ANTE IN RETE*2 panels grid door / 2 panneaux porte grille / 2 Flügel Gittertür*

| Cod. | ↔ | ↙ | ↕ | Kg |
|-----------|------|---|------|-------|
| 102293/nr | 1400 | - | 2000 | 45,52 |
| 102183/nr | 1600 | - | 2000 | 39,04 |

PORTA 2 ANTE IN LAMIERA CHIUSA*2 panels plain steel door / porte avec 2 panneaux en métal / 2 Flügel Blechtür*

| Cod. | ↔ | ↙ | ↕ | Kg |
|-----------|------|---|------|-------|
| 102313/nr | 1400 | - | 2000 | 52,12 |
| 102193/nr | 1600 | - | 2000 | 56,72 |

PORTA 2 ANTE RETE/LAMIERA CHIUSA*2 panels plain steel/grid combined door / 2 panneaux porte avec 2 panneaux en métal/grille / 2 Flügel Blech- und Gittertür*

| Cod. | ↔ | ↙ | ↕ | Kg |
|-----------|------|---|------|-------|
| 102303/nr | 1400 | - | 2000 | 48,82 |
| 102173/nr | 1600 | - | 2000 | 52,88 |

PORTONE SCORREVOLE RETE/LAMIERA CHIUSA*Plain steel - grid combined sliding door / porte coulissante en métal - grille / Verschiebbare Blech- und Gittertür*

| Cod. | ↔ | ↙ | ↕ | Kg |
|-----------|---|---|---|-------|
| 102213/mq | - | - | 4 | 33,90 |

**CANCELLO BASCULANTE****lunghezza massima 2550mm altezza massima 1900 mm***Safety gate - max length 2550 mm max height 1900 mm**Barrière de sécurité max longueur 2550 mm max hauteur 1900 mm**Geländerschleuse - max Länge 2550mm max Höhe 1900mm*

| Cod. | ↔ | ↙ | ↕ | Kg |
|-----------|------|---|------|-------|
| 111383/nr | 1895 | - | 1900 | 97,57 |



PIANO E
Shelf E - Tablette E - Regal E

| Cod. | ↔ | ↙ | ↕ | Kg |
|--------|-----|-----|-----|------|
| 112013 | 920 | 288 | 113 | 3,71 |
| 112103 | 920 | 408 | 179 | 6,09 |
| 112203 | 920 | 508 | 179 | 7,33 |

PIANO F/B
Shelf F/B - Tablette F/B - Regal F/B

| Cod. | ↔ | ↙ | ↕ | Kg |
|--------|-----|-----|-----|------|
| 112183 | 920 | 408 | 113 | 4,03 |
| 112633 | 920 | 508 | 113 | 5,11 |



PIANO F
Shelf F - Tablette F - Regal F

| Cod. | ↔ | ↙ | ↕ | Kg |
|--------|-----|-----|-----|------|
| 112023 | 920 | 288 | 113 | 3,10 |

PIANO G
Shelf G - Tablette G - Regal G

| Cod. | ↔ | ↙ | ↕ | Kg |
|--------|-----|-----|-----|------|
| 112033 | 920 | 288 | 113 | 3,28 |
| 112123 | 920 | 408 | 179 | 4,95 |
| 112223 | 920 | 508 | 179 | 6,71 |





PIANO H
Shelf H - Tablette H - Regal H

| Cod. | ↔ | ↙ | ↕ | Kg |
|--------|-----|-----|-----|------|
| 112043 | 920 | 288 | 113 | 3,23 |
| 112133 | 920 | 408 | 179 | 5,09 |
| 112233 | 920 | 508 | 179 | 6,69 |



PIANO P
Shelf P - Tablette P - Regal P

| Cod. | ↔ | ↙ | ↕ | Kg |
|--------|-----|-----|-----|-------|
| 112063 | 905 | 288 | 130 | 10,36 |
| 112193 | 905 | 408 | 130 | 13,47 |



PIANO TV
Shelf TV - Tablette TV - Regal TV

| Cod. | ↔ | ↙ | ↕ | Kg |
|--------|-----|-----|----|------|
| 112073 | 925 | 288 | 30 | 3,35 |
| 112153 | 925 | 408 | 30 | 5,14 |
| 112283 | 925 | 508 | 30 | 5,97 |
| 112593 | 925 | 608 | 30 | 6,89 |



LINEA PRATIC_LEVEL

PIANO I
Shelf I - Tablette I - Regal I

| Cod. | ↔ | ↙ | ↕ | Kg |
|--------|-----|-----|-----|------|
| 112053 | 920 | 288 | 113 | 3,79 |
| 112143 | 920 | 408 | 179 | 6,03 |
| 112243 | 920 | 508 | 179 | 7,27 |



LINEA PRATIC_LEVEL



PIANO E ATTACCO FRONTALE MONTANTE BIFRONTE

Shelf E
Tablette E
Regal E

Front connection double sided uprights
Connexion frontale montant bifrontal
Vorderanschluss - zweiseitige Träger

| Cod. | ↔ | ↙ | ↕ | Kg |
|--------|-----|-----|-----|------|
| 112303 | 564 | 288 | 113 | 3,59 |
| 112313 | 804 | 288 | 113 | 4,44 |



PIANO I ATTACCO FRONTALE MONTANTE BIFRONTE

Shelf I
Tablette I
Regal I

Front connection double side uprights
Connexion frontale montant bifrontal
Vorderanschluss - zweiseitige Träger

| Cod. | ↔ | ↙ | ↕ | Kg |
|--------|-----|-----|-----|------|
| 112273 | 564 | 288 | 113 | 3,94 |



CESTONE IN FILO METALLICO C

Metallic wire basket - Panier métallique - Drahtkorb

| Cod. | ↔ | ↙ | ↕ | Kg |
|--------|-----|-----|-----|------|
| 224244 | 930 | 400 | 300 | 4,00 |
| 224245 | 930 | 500 | 300 | 6,00 |



PIANO F ATTACCO FRONTALE MONTANTE BIFRONTE

Shelf F
Tablette F
Regal F

Front connection double sided uprights
Connexion frontale montant bifrontal
Vorderanschluss - zweiseitiger Träger

| Cod. | ↔ | ↙ | ↕ | Kg |
|--------|-----|-----|-----|------|
| 112323 | 564 | 288 | 113 | 3,58 |
| 112333 | 804 | 288 | 113 | 4,37 |





PIANO SMONTABILE

Modular shelf - Tablette démontable - Modular Regal

| Cod. | ↔ | ↙ | ↕ | Kg |
|--------|-----|-----|-----|-----|
| 122013 | 930 | 260 | 185 | 3,6 |
| 122023 | 930 | 300 | 185 | 3,9 |
| 122033 | 930 | 330 | 185 | 4,3 |



PIOLO PER STAFFA

*Support holder
Séparateur tubulaire
Bügelständer*

| Cod. | ↔ | ↙ | ↕ | Kg |
|--------|---|---|-----|------|
| 113204 | - | - | 100 | 0,06 |
| 113194 | - | - | 200 | 0,10 |



STAFFA PORTA PROFILI FORATA E VERNICIATA

Punched, painted support - Bras perforés - Gestanzter lackierter Bügel

| Cod. | ↔ | ↙ | ↕ | Kg |
|--------|---|---|-----|------|
| 113584 | - | - | 400 | 0,60 |
| 113594 | - | - | 500 | 0,72 |

STAFFA FORATA AD AGGANCIO PER BARRA MR

*Punched hanging support for MR bar
Support percé pour MR Serie
Gestanzter lackierter Bügel für MR*

| Cod. | ↔ | ↙ | ↕ | Kg |
|--------|---|---|-----|------|
| 113244 | - | - | 400 | 0,47 |

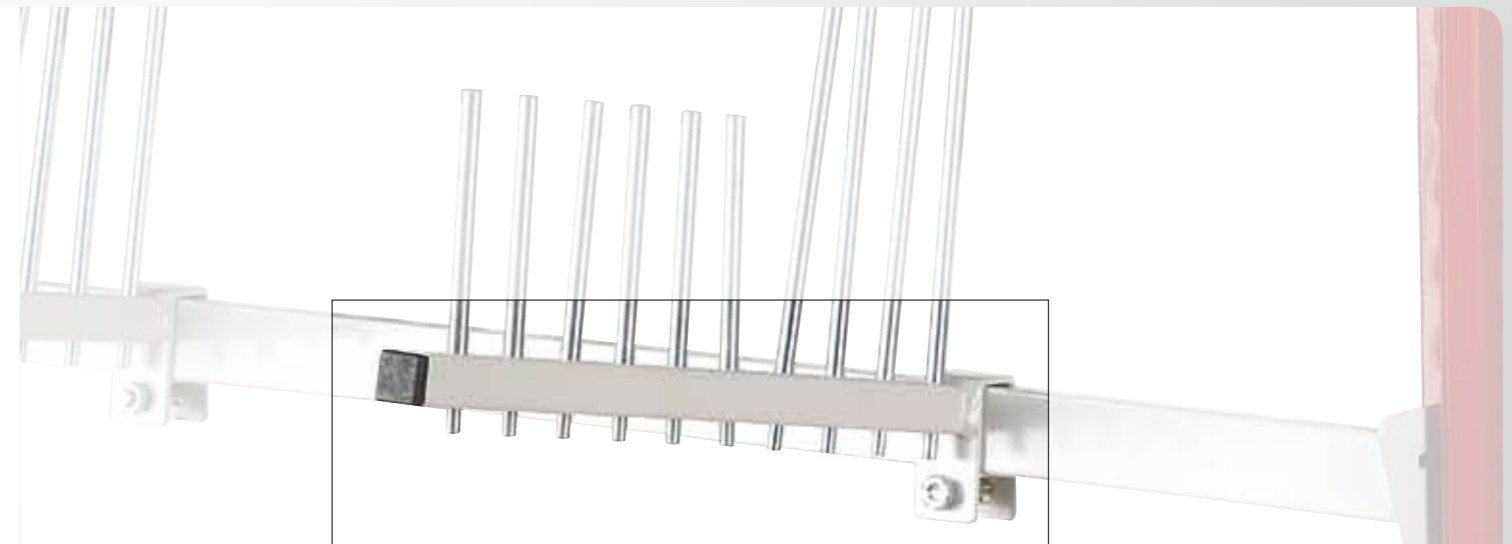



PIANO TUBOLARE APPENDIABILI
Tubular hangers - Portant tubulaire - Rohraufhänger

| Cod. | ↔ | ↙ | ↕ | Kg |
|--------|-----|-----|---|------|
| 113604 | 930 | 330 | - | 1,40 |

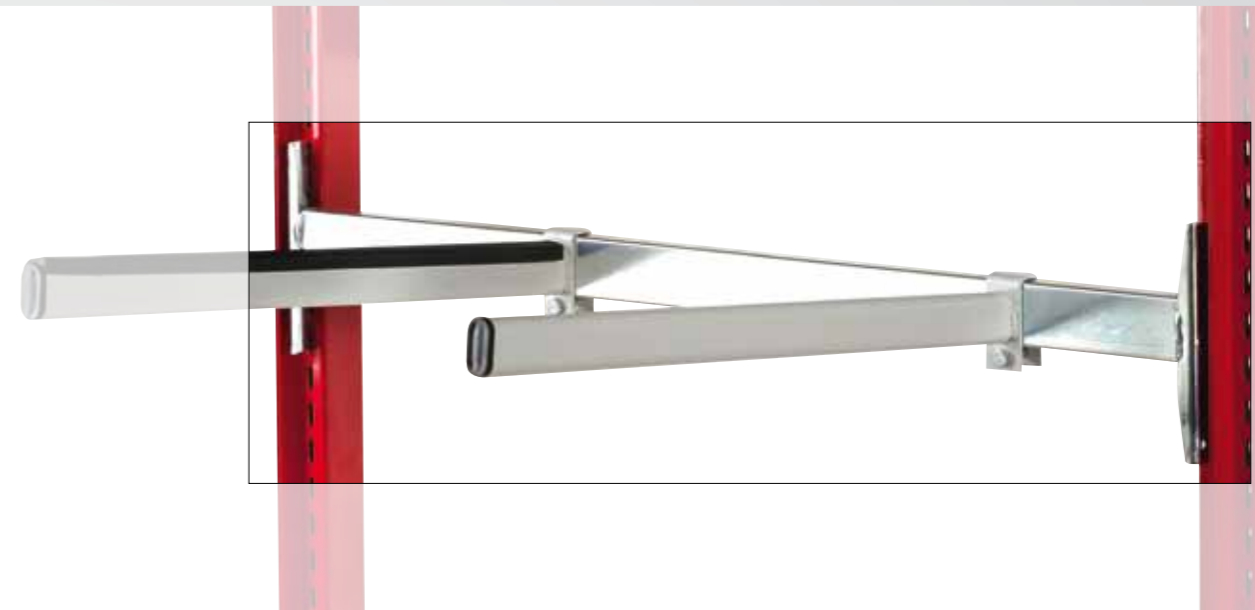

STAFFA PORTAPARAURTI PER MR50 CON GOMMA
Bumper holder for MR Serie with PVC cover
Support pare-choc pour Serie MR couverture en PVC
Stoßstangenbügel für MR Serie Gummibeschichtung

| Cod. | ↔ | ↙ | ↕ | Kg |
|--------|---|---|-----|------|
| 113293 | - | - | 600 | 0,90 |



MENSOLA TUBOLARE PORTALUNOTTI
Tubing bar for rear windows - Tablette pour lunettes arrières - Heckscheiberegale

| Cod. | ↔ | ↙ | ↕ | Kg |
|--------|-----|----|----|------|
| 113583 | 600 | 90 | 20 | 0,94 |



STAFFA PORTAPARAURTI PER MR50
Bumper holder for MR Serie - Support pare-choc pour Serie MR - Stoßstangebügel für MR Serie

| Cod. | ↔ | ↙ | ↕ | Kg |
|--------|-----|---|---|------|
| 113503 | 700 | - | - | 0,95 |
| 113513 | 800 | - | - | 1,07 |

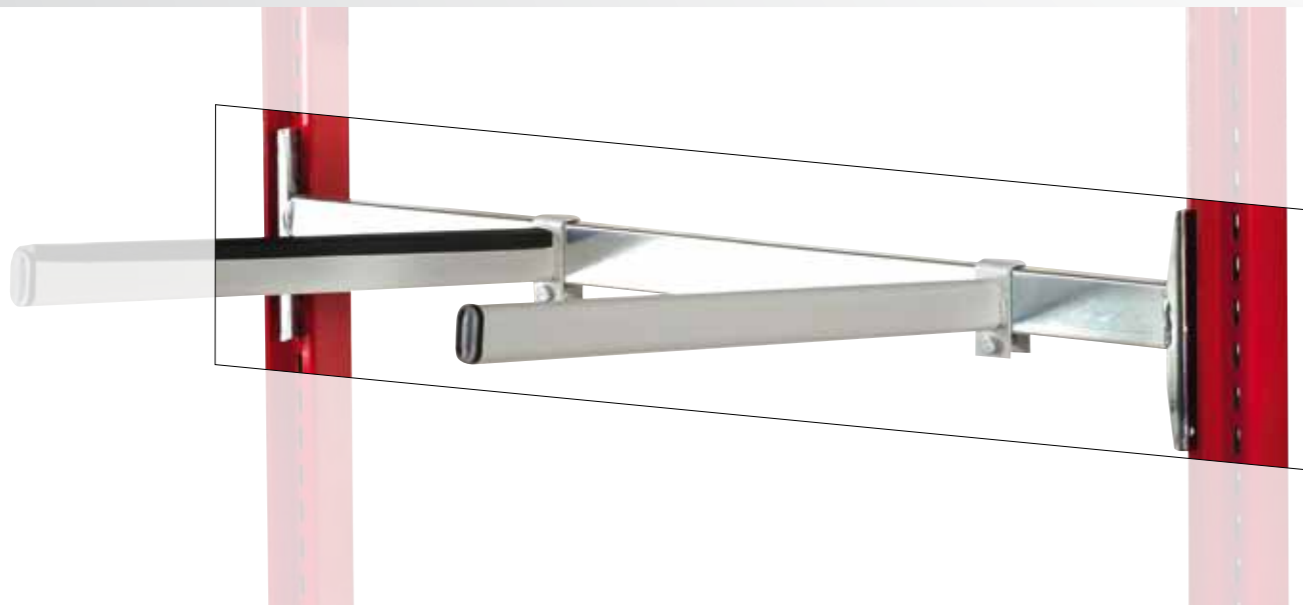



BARRA MR

MR bar
MR barre
MR Stange

| Cod. | ↔ | ↙ | ↕ | Kg |
|--------|-----|----|----|------|
| 113054 | 925 | 20 | 35 | 1,38 |
| 113074 | 925 | 20 | 50 | 3,27 |



PIANO RS PROFONDITÀ REGOLABILE

RS shelf
RS Tablette
RS Regale

adjustable depth
profondeur réglable
regulierbare Tiefe

| Cod. | ↔ | ↙ | ↕ | Kg |
|--------|-----|---------|-----|------|
| 113003 | 920 | 400-500 | 508 | 1,15 |



STAFFA

Broche support - Support MR - MR Bügel

| Cod. | ↔ | ↙ | ↕ | Kg |
|--------|-----|----|---|------|
| 113414 | 280 | 6 | - | 0,15 |
| 113404 | 280 | 10 | - | 0,25 |
| 113444 | 400 | 6 | - | 0,18 |
| 113434 | 400 | 10 | - | 0,32 |



SEPARATORE TUBOLARE PER PIANO RS

Tube separator for RS shelving - Separateur tubulaire pour Tablette RS - Rohrseparator für RS-Regale

Ø 20 mm

| Cod. | ↔ | Kg |
|--------|-----------------|------|
| 113274 | 400 | 0,33 |
| 113254 | 400 gummi cover | 0,79 |
| 113524 | 500 | 0,40 |





PIANO PORTA AMMORTIZZATORI - 10 POSIZIONI

*Shock absorber shelf - 10 pieces
Tablette amortisseur - 10 pièces
Dämpferregale - 10 Positionen*

| Cod. | ↔ | ↙ | ↕ | Kg |
|--------|-----|-----|-----|------|
| 113463 | 920 | 408 | 195 | 7,03 |

PIANO PORTA AMMORTIZZATORI - 21 POSIZIONI

*Shock absorber shelf - 21 pieces
Tablette amortisseur - 21 pièces
Dämpferregale - 21 Positionen*

| Cod. | ↔ | ↙ | ↕ | Kg |
|--------|-----|-----|-----|------|
| 113473 | 920 | 408 | 195 | 6,65 |

PIANO PORTABATTERIE - 4 POSTI

*Battery holder shelf - 4 pieces
Tablette Batterie - 4 pièces
Akkuregale - 4 Positionen*

| Cod. | ↔ | ↙ | ↕ | Kg |
|--------|-----|-----|-----|-------|
| 113483 | 920 | 408 | 175 | 11,59 |



PIANO PCV

*Shelf PCV
Tablette PCV
Regal PCV*

| Cod. | ↔ | ↙ | ↕ | Kg |
|--------|-----|-----|---|------|
| 113153 | 930 | 288 | - | 3,21 |



DIVISORIO PER PIANO TIPO E CON PORTAETICHETTA

*E shelf separator with label holder
Separateur pour tablette E avec porte-étiquette
Regal E Trennwand mit Trägeretichette*

| Cod. | ↔ | ↙ | ↕ | Kg |
|--------|-----|---|-----|------|
| 112363 | 278 | - | 105 | 0,34 |
| 112393 | 388 | - | 165 | 0,59 |
| 112433 | 480 | - | 165 | 0,74 |





DIVISORIO PER PIANO TIPO I CON PORTAETICHETTA

*I shelf separator with label holder
Séparateur pour tablette I avec porte-étiquette
Regal I Trennwand mit Trägeretichette*

| Cod. | ↔ | ↙ | ↕ | Kg |
|--------|-----|---|-----|------|
| 112383 | 270 | - | 105 | 0,37 |
| 112413 | 380 | - | 165 | 0,61 |
| 112453 | 480 | - | 165 | 0,79 |

PORTAETICHETTA ZINCATO

*Galvanised label holder
Porte-étiquette galvanisé
Verzinkte Etikettenhalter*

| Cod. | ↔ | ↙ | ↕ | Kg |
|--------|----|---|----|------|
| 112504 | 78 | - | 27 | 0,03 |



DIVISORIO PER PIANO F - F/B CON PORTAETICHETTA

*F - F/B shelf separator with label holder
Séparateur pour tablette F - F/B avec porte-étiquette
Regal F - F/B Trennwand mit Trägeretichette*

| Cod. | ↔ | ↙ | ↕ | Kg |
|--------|-----|---|-----|------|
| 112373 | 270 | - | 105 | 0,25 |
| 112423 | 380 | - | 105 | 0,34 |
| 112473 | 480 | - | 105 | 0,38 |

PORTAETICHETTA MAGNETICO

*Magnetic label holder
porteétiquette magnétique
magnetische Etikettenhalter*

| Cod. | ↔ | ↙ | ↕ | Kg |
|--------|----|---|----|------|
| 210020 | 78 | - | 27 | 0,03 |

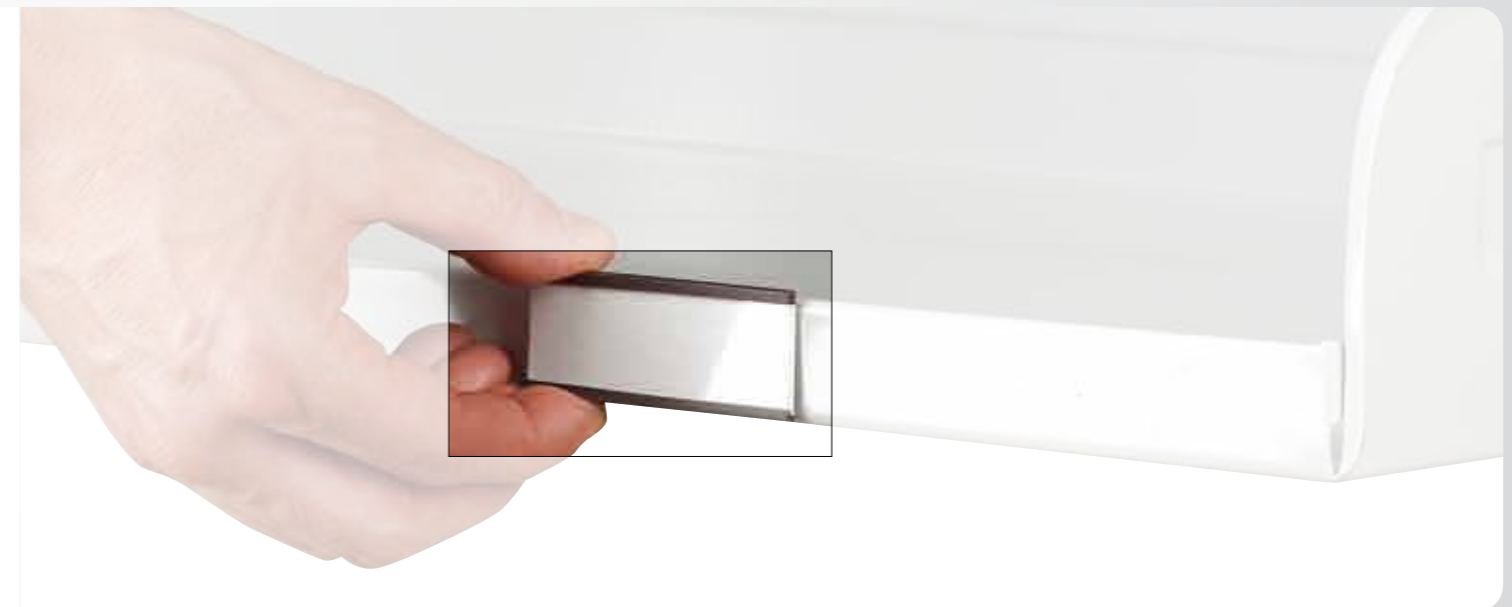

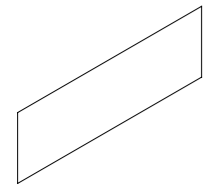

ETICHETTA IN CARTONCINO
 Labelcard
 Étiquette blanche
 Etikell

| Cod. | ↔ | ↙ | ↕ | Kg |
|--------|----|---|----|------|
| 112515 | 75 | - | 20 | 0,01 |

PROTEZIONE IN PLASTICA
 Plastic labelcard cover
 Protège étiquette en plastique
 Plastik-Etikettenschutz

| Cod. | ↔ | ↙ | ↕ | Kg |
|--------|----|---|----|------|
| 112525 | 75 | - | 25 | 0,01 |

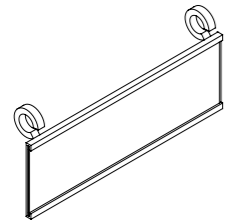

PORTAETICHETTE CESTONE
 Label holder basket
 Porte-étiquette panier
 Etikettenhalter Drahtkorb

| Cod. | ↔ | ↙ | ↕ | Kg |
|--------|-----|---|----|------|
| 224233 | 120 | - | 40 | 0,05 |
| 224234 | 170 | - | 80 | 0,10 |

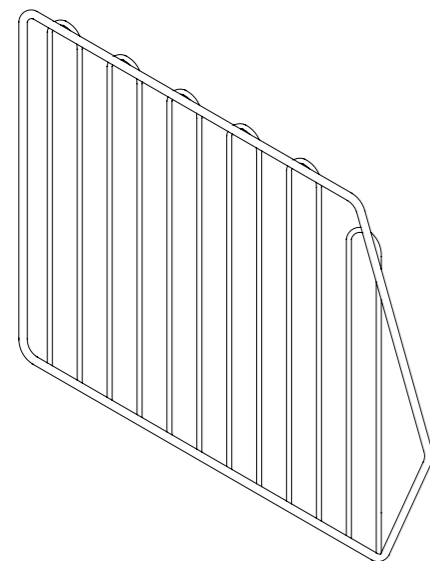

DIVISORIO CESTONE
 Basket separator
 Separateur pour panier
 Drahtkorbpartition

| Cod. | ↔ | ↙ | ↕ | Kg |
|--------|-----|---|----|------|
| 224254 | 400 | - | 25 | 0,60 |
| 224255 | 500 | - | 25 | 0,80 |

La Rigenerazione del Magazzino
 The Storing System Regeneration

40°

1973 - 2011



